

ACO TRESHOLD	INSTALLATION DRAWINGS	
DRWG# TRESHOLD	ThresholdDrain	
www.aconz.co.nz		

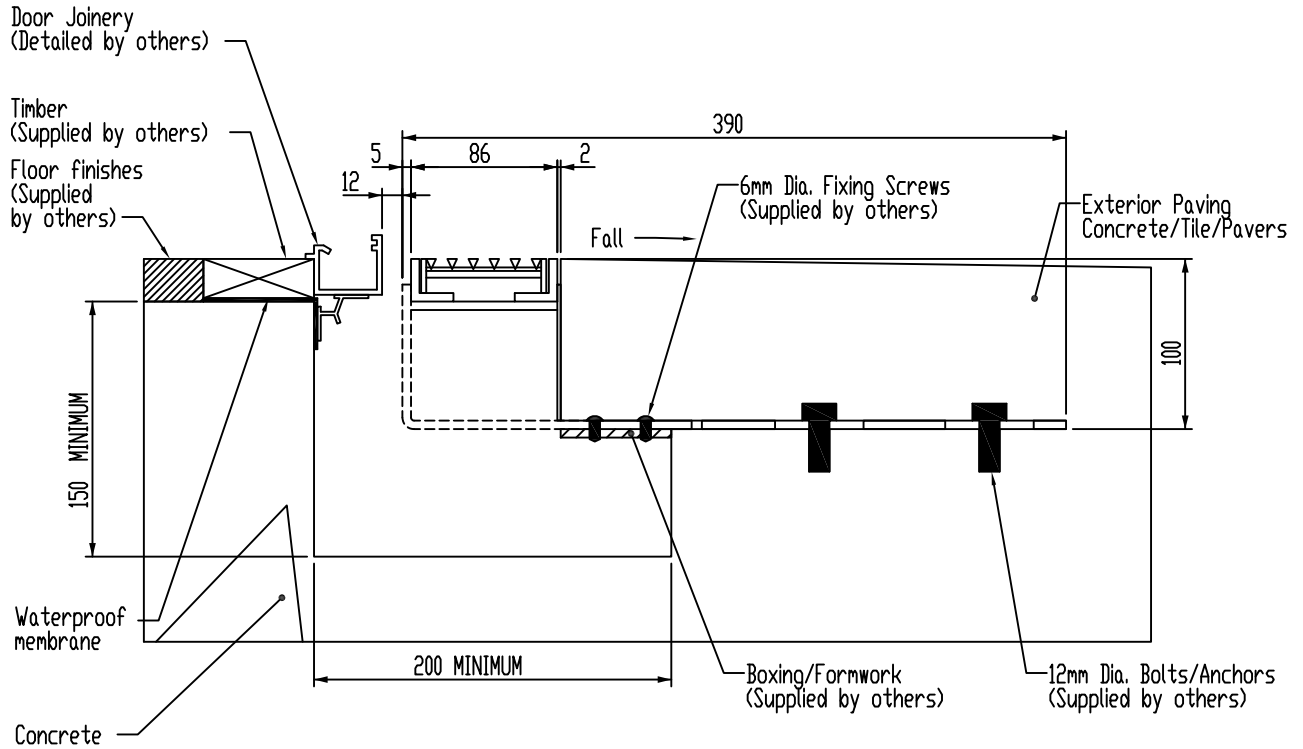

©2017 ACO Limited

NOTES:

- 1.. Customers to check and confirm the installation details meet NZ Building Code E2 Solutions Figure 17B.
- 2.. ACO recommends designers and installers check local legislative standards and practices, or seek specialised

ACO TRESHOLD	SPECIFICATION CLAUSE	ACO Limited Unit F/6 Percival Gull Place Mangere, Auckland 2022 Tel: 0800 448 080 Fax: +64 9255 5114 Email: info@aconz.co.nz
DRWG# TRESHOLD	ThresholdDrain	
www.aconz.co.nz		

ThresholdDrain complete with "grate type"* grate shall be installed as per ACO's installation detail with reference to NZ Building Code E2 Solutions Figure 17B.

Grate shall be 73mm wide. Channel shall be 86mm wide. The length, as specified, on designers plans/specifications.

The system shall be manufactured and supplied by ACO Limited and installed in accordance with ACO's guidelines.

Installers must check local plumbing codes and seek professional advice prior to installation.

* Insert grate type.